

Uniden[®]

ULP1000

**LASER POCKET PROJECTOR
and VGA DOCK**

OWNER'S MANUAL

Table of Contents

Important Safety Information	4
Safety Labels	6
Laser Specifications	7
Declarations	7
Package Contents	8
ULP1000 Laser Pico Projector	9
Introduction.....	10
Getting Started.....	11
Install Battery	11
Charge Battery	12
Power ON or OFF	13
Usage Guidelines	14
Connect to a Video Source.....	16
How to Connect to an Apple iPod®	16
Connecting to Other Composite (TV-out) Video Sources.....	18
Connecting to a Laptop Computer Using the VGA DOCK	20
VGA DOCK: Computer Display Settings	22
Supported Resolutions	23
Computer Compatibility	23
Windows XP Display Settings.....	24
Windows Vista Display Settings.....	26
Mac OSX	27

Advanced Controls	28
Menu Controls	28
Onscreen Menu	28
How to Adjust Brightness	29
How to Change Colour Mode	29
How to Adjust Aspect Ratio.....	29
How to Adjust the Image Alignment	29
How to Adjust the Colour Alignment	30
How to Reset Default Settings	30
How to Check Remaining Battery Life	31
Care & Maintenance	31
How to Clean the Window	31
How to Store & Transport	31
How to Use the Audio Jack.....	31
Troubleshooting	32
LED Status & Meaning	33
Customer Support.....	33
One Year Limited Warranty	34

Important Safety Information

PLEASE READ, UNDERSTAND AND FOLLOW ALL SAFETY INFORMATION IN THIS USER GUIDE BEFORE YOU USE THIS PROJECTOR. FAILURE TO PROPERLY SET UP, USE, AND CARE FOR THIS PROJECTOR CAN INCREASE THE RISK OF INJURY, OR DAMAGE TO THE PROJECTOR. KEEP THIS USER GUIDE FOR FUTURE REFERENCE.

Intended Use Statement

The ULP1000 laser pico projector is designed to operate with the Uniden-specified battery and Uniden battery charger in a normal office and home environment within the following parameters:

- » Operating Temperature: 10°- 30° C, (50° - 86° F)
- » Storage Temperature: non-operating: -20°- 60° C, (-4°- 140° F) with battery
- » Humidity: 10 - 85% relative humidity (without condensation)
- » Altitude: -152M - 4572M (-500 - 15,000 ft.)



Indicates a potentially hazardous situation, which if not avoided, may result in death or serious injury and/or property damage.

AS WITH ANY BRIGHT LIGHT SOURCE, DO NOT STARE INTO THE BEAM. STARING INTO THE BEAM COULD CAUSE EYE DISCOMFORT AND IMPAIR VISION.

AS WITH ANY PRODUCT CONTAINING LASERS, DO NOT DISASSEMBLE THE PROJECTOR FOR ANY REASON. DISSASSEMBLING THE PROJECTOR MAY RESULT IN HAZARDOUS LASER RADIATION EXPOSURE.

EXCEPT FOR OPENING THE BATTERY DOORAS DIRECTED IN THIS USER GUIDE TO REPLACE THE BATTERY, THERE ARE NO USER SERVICABLE PARTS INSIDE THE PROJECTOR.

For service or repair the product must be returned to an authorized repair facility. See Customer Support section within this User Guide for details.

To avoid risks associated with laser exposure:

- » Not recommended for use by children under 14 unless supervised by an adult. The ULP1000 is not a toy.
- » Use of controls or adjustments or performance of procedures other than those specified in this User Guide may result in hazardous laser radiation exposure

To avoid risks associated with hazardous voltage:

- » Do not modify this product in any way. Use only Uniden approved replacement components.
- » Do not use the AC adapter in a wet environment.
- » No not use with a damaged AC adapter. Replace damaged AC adapter prior to use.

To avoid risks associated with fire and explosion:

- » Do not immerse the projector or battery in any liquid or allow either to get wet.
- » Use only AC adapter and battery provided by Uniden.
- » Do not disassemble the battery or modify it in any way.
- » Do not attempt to short out the battery.

- » Do not expose the battery to temperatures under -20°C or above 60°C.
- » Do not crush the battery.
- » Do not overcharge or rapidly discharge the battery.
- » Do not dispose of the battery by incineration or fire.
- » Do not expose the projector or battery to direct sunlight in a closed space such as a vehicle.

To avoid risks of other injuries:

- » Do not handle a damaged or leaking battery pack.
- » Do not handle a battery that has been handled in an inappropriate or dangerous manner.

To avoid risks associated with driver distraction in a moving vehicle:

- » Do not use this projector in a moving vehicle in a manner that may distract the driver.



Indicates a potentially hazardous situation, which if not avoided, may result in minor or moderate injury and/or property damage.

- » Do not point the projected image at people, vehicles, or aircraft.
- » Risk of explosion if battery is replaced by an incorrect type.
- » Dispose of used batteries according to the instructions contained within this guide.

To avoid risks associated with environmental contamination:

- » Dispose of all system components in accordance with applicable government regulations.

To avoid risks associated with tripping and falling:

- » Position the charging cord and data cables so that they can not be tripped over.

Photosensitive Seizure Warning

A very small percentage of people may experience seizures or blackouts that are triggered by exposure to light flashes or certain visual images including flashing lights or patterns that may appear in video games or other video images. Even people who have no history of seizures or blackouts could experience “photosensitive epileptic seizures” while watching some video images.

Immediately stop watching projected video images and consult a physician if you experience symptoms such as lightheadedness, altered vision, eye or face twitching, convulsions, disorientation, confusion or momentary loss of awareness.

Taking the following precautions while watching video may help reduce the risk of photosensitive epileptic seizures.

- » Avoid use while tired or fatigued.
- » Take frequent breaks.
- » Look away from the screen from time to time.
- » Sit further away from the projected image.

Safety Labels

The ULP1000 Laser Pico Projector is a CLASS 2 LASER PRODUCT as defined in IEC 60825-1, 2007-03. The ULP1000 has been designed to be safe for general use as a mobile projector.

IEC and CDRH Statements of Compliance

The ULP1000 complies with IEC 60825-1, 2007-03.

The following safety labels are affixed at the factory.

THESE LABELS CONTAIN IMPORTANT SAFETY INFORMATION.
DO NOT REMOVE THEM.

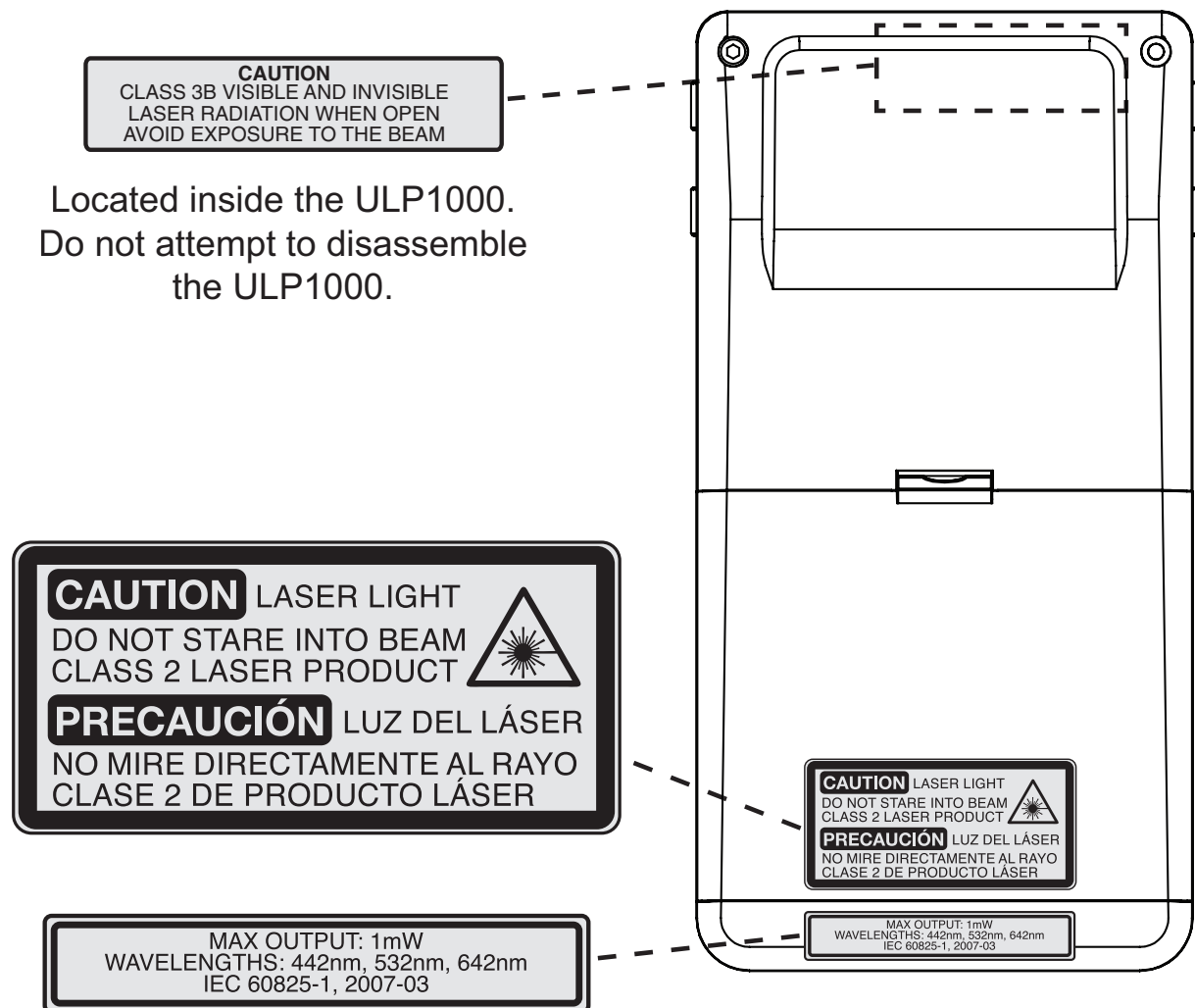

Laser Specifications

Laser Colour	Red		Blue		Green	
Laser Type	AlGaInP laser diode		GaN laser diode		Frequency doubled IR laser diode	
Max CW Output	90 mW		50 mW		60 mW	
Divergence Slow-Axis	7°, FWHM	13°, FWHM	4°, FWHM	15°, FWHM	5°, 1/e2	10°, 1/e2
Divergence Fast-axis	16°, FWHM	24°, FWHM	15°, FWHM	25°, FWHM	12°, 1/e2	18°, 1/e2
Wavelength	635 nm	645 nm	440 nm	460 nm	526 nm	537 nm

Declarations

Caution: Changes or modifications to this equipment not expressly approved by manufacturer could void the user's authority to operate this equipment.

CE Statement

This product complies with the requirements of the Low Voltage Directive 2006/95/EC and the EMC Directive 2004/108/EC and carries the CE mark accordingly.



Product Disposal

The ULP1000 laser pico projector should not be placed in household waste bins. Please check local regulations for information about the disposal of electronic products in your area.

Made for iPod

Made for iPod means that an electronic accessory has been designed to connect specifically to iPod and has been certified by the developer to meet Apple performance standards. Apple is not responsible for the operation of this device or its compliance with safety and regulatory standards. iPod is a trademark of Apple Inc., registered in the U.S. and other countries.

Copyright & Trademarks

© 2009 Uniden Australia Pty Ltd/Uniden New Zealand Ltd. All rights reserved. iPod, and Made for iPod are trademarks of Apple, Inc., registered in the U. S. and other countries. Apple is not responsible for the operation of this device or its compliance with safety and regulatory standards. PicoP is a trademark of Microvision, Inc.

Package Contents

Please make sure you have received all items included with the product. If any items are missing contact your place of purchase immediately.

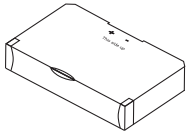

ULP1000
Rechargeable
Battery

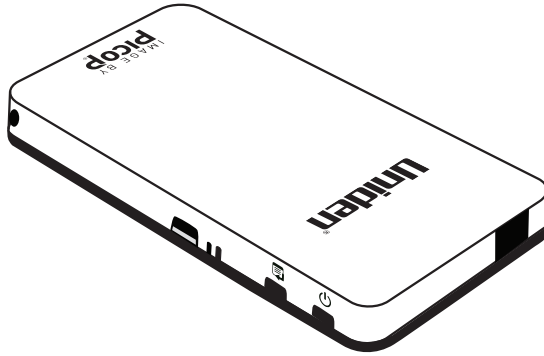

ULP1000
Laser Pico Projector

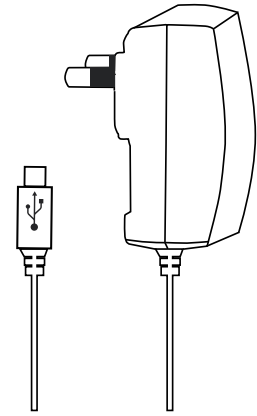

ULP1000
Wall Charger

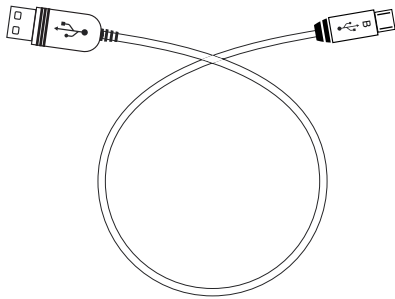

Micro-USB cable

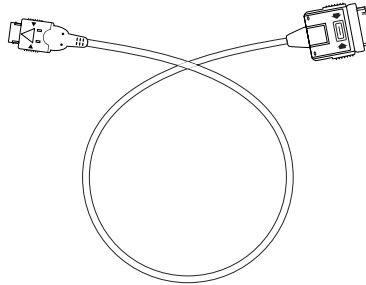

ULP1000
Cable for iPod

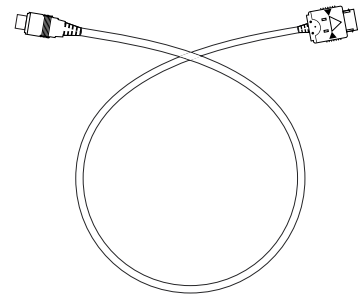

ULP1000
Composite Adaptor

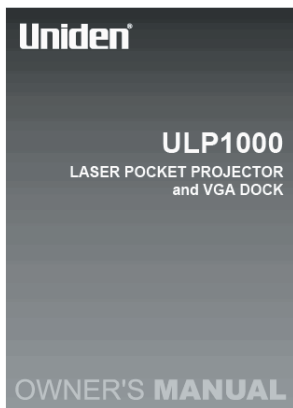

Owner's Manual

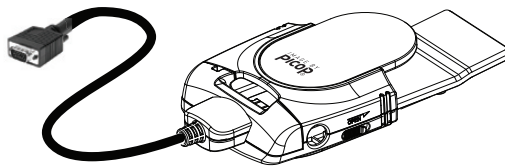

VGA DOCK

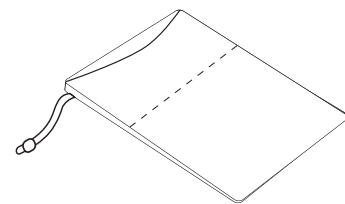

Storage Pouch

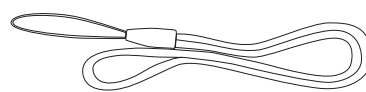

Wrist Strap

ULP1000 Laser Pico Projector

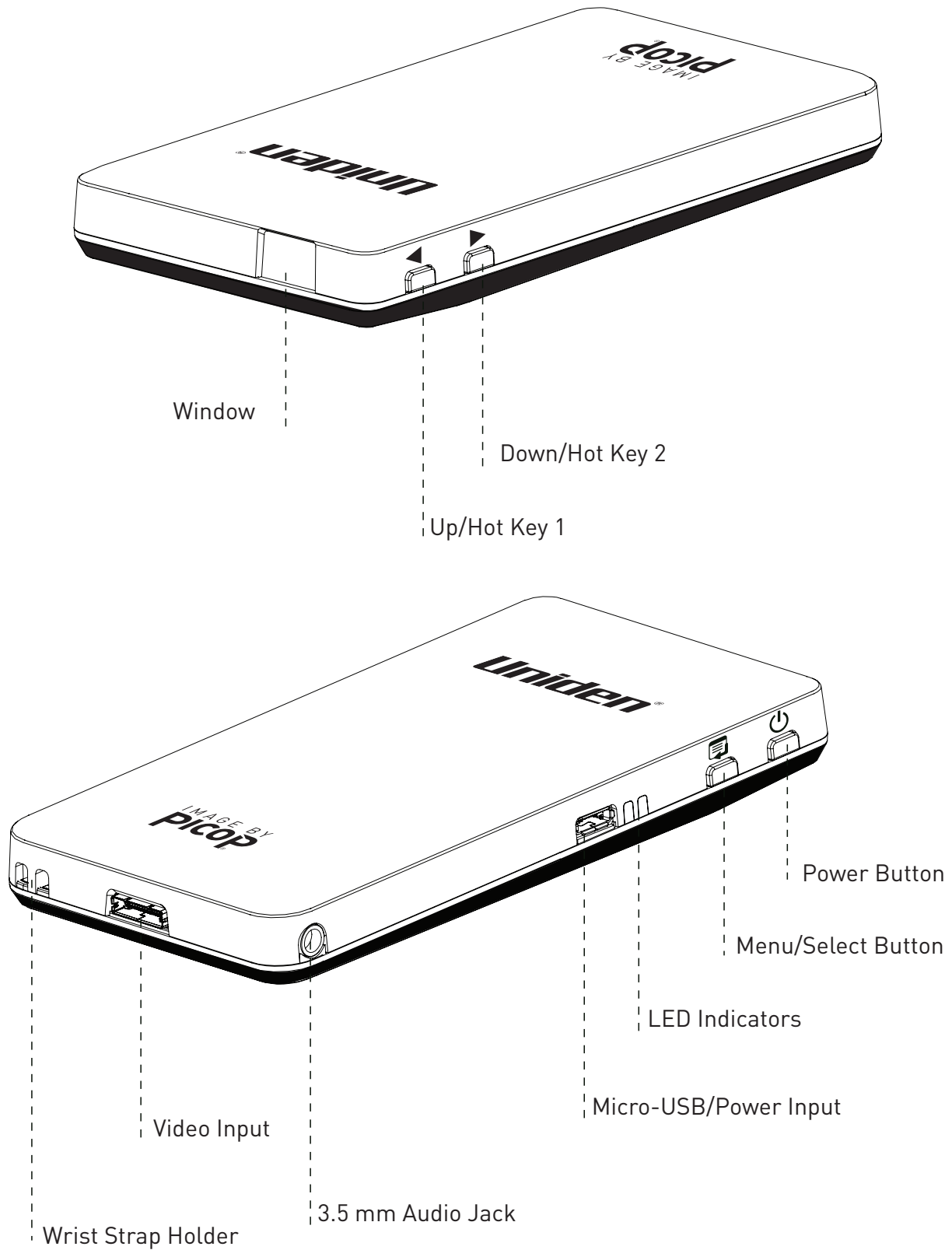

Introduction

Thank you for purchasing the Uniden ULP1000 laser pico projector. The ULP1000 projects big, bright, and colourful images that are always in focus, yet is small enough to fit in your pocket. Connect the ULP1000 to a video output-capable device to spontaneously share photos and videos, presentations and more, in a big screen experience.

What is the PicoP® Display Engine?

The PicoP display engine is the world's first ultra miniature laser-based projector engine. It uses red, green and blue laser light sources, electronics, optics, and a unique, tiny mirror-like device that "paints" the image line-by-line on the projection surface.

IMAGE BY
PICOP®

Getting Started

Install Battery

- 1 Remove Battery Door

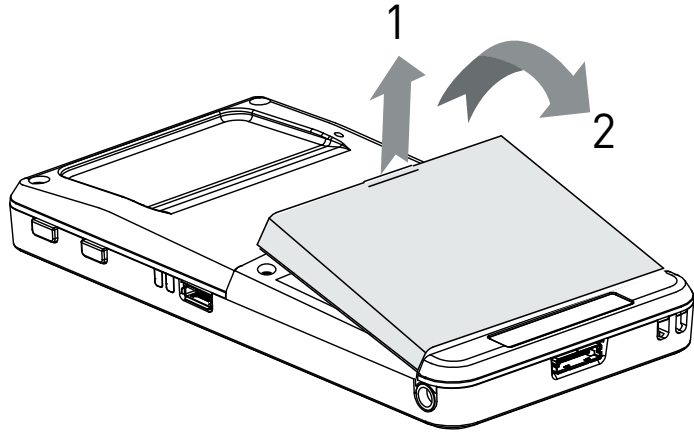

- 2 Insert Battery

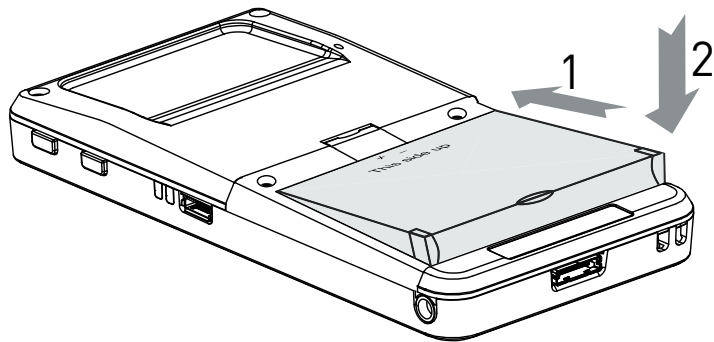

- 3 Close Battery Door

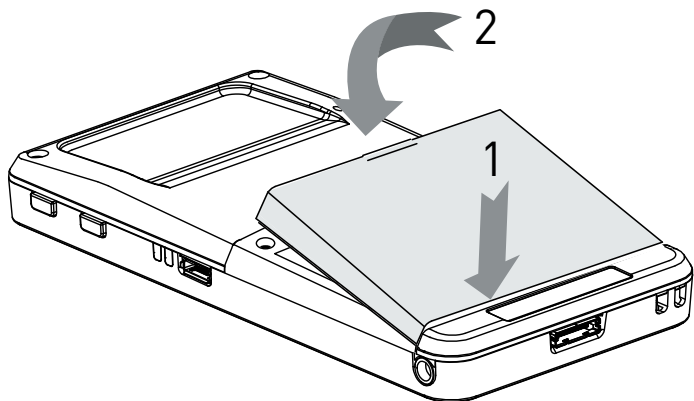

- » Make sure the projector is OFF and unplugged before replacing the battery.
- » Do not force the battery in. Make sure the battery + / - symbols are lined up.

Charge Battery

- 1 Plug Wall Charger Into Outlet

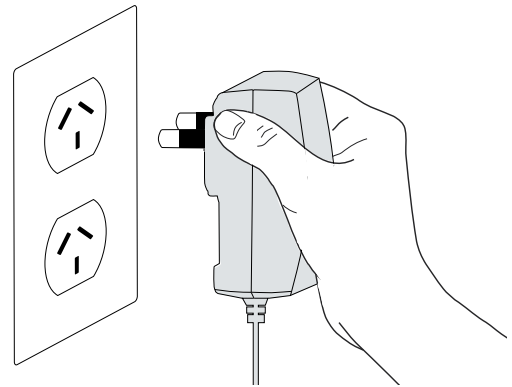

- 2 Connect To Micro-USB/Power Input

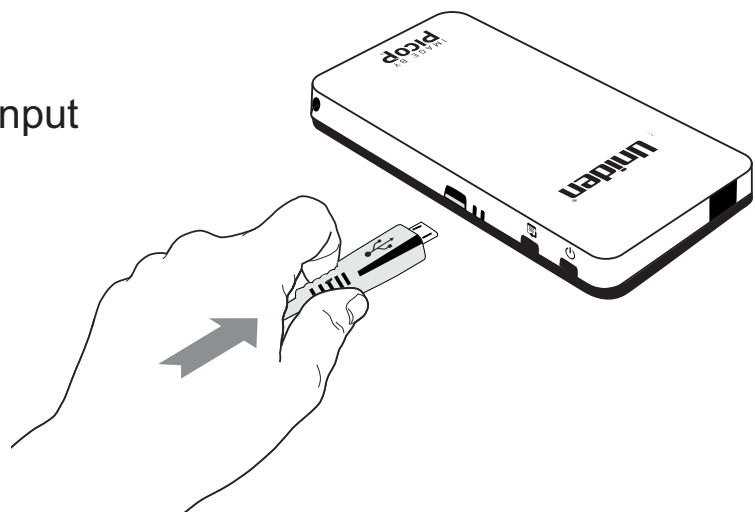

- 3 Orange LED: Battery charging
Green LED: Battery fully charged

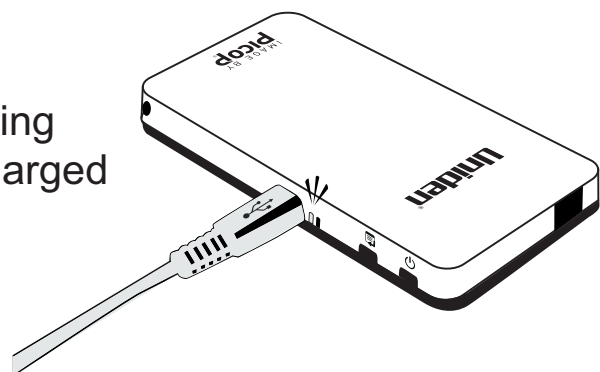



Note:

- » Allow for a minimum of 4 hours charging before first time use.
- » The wall charger will not charge the battery while the ULP1000 is powered ON.
- » The supplied battery is designed specifically for the ULP1000 and no other battery should be used.

Power ON or OFF

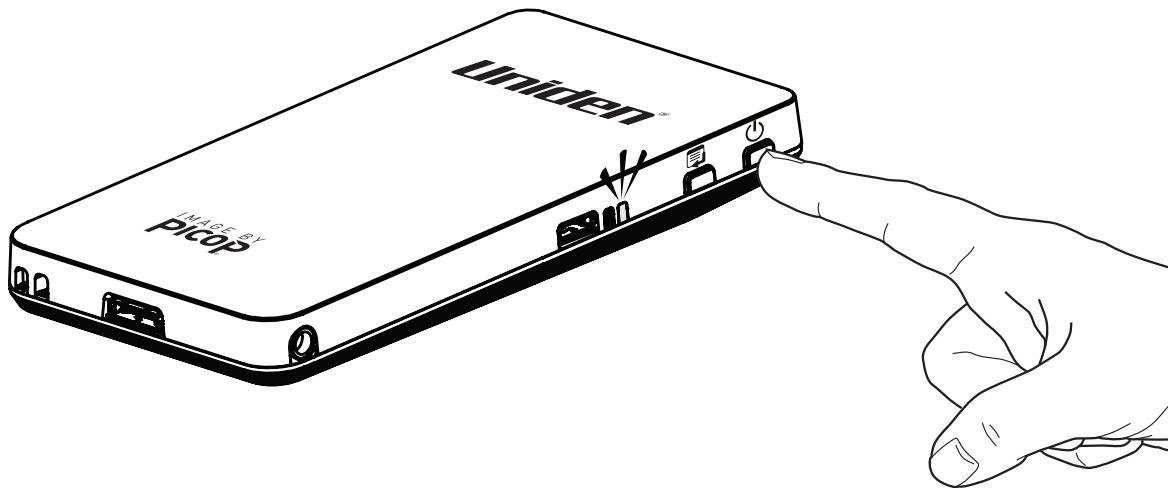
Note: Do not have the ULP1000 connected to any video device before turning ON.



Turning ON: Press and hold the  button.
The blue LED will come on and the image will appear in about 15 seconds.

Note:

- » During startup the image will flash with a series of different colours.
This is normal.
- » A blinking Blue LED indicates the unit is starting up.
A solid Blue LED indicates the unit is ready for use.

Turning OFF: Press the  button.

Usage Guidelines

There are two main factors to consider when using the ULP1000.

Ambient light

» It is recommended to shut blinds, close curtains and turn lights down to make the room dark so the projected image looks the best.

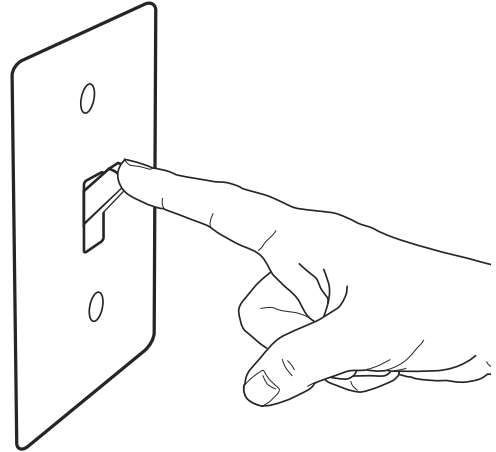

Distance from screen

» The projector distance from the screen will impact the appearance of the image brightness. The closer to the screen the brighter the image will appear.

The following is a guideline of what image sizes are possible under various lighting conditions:

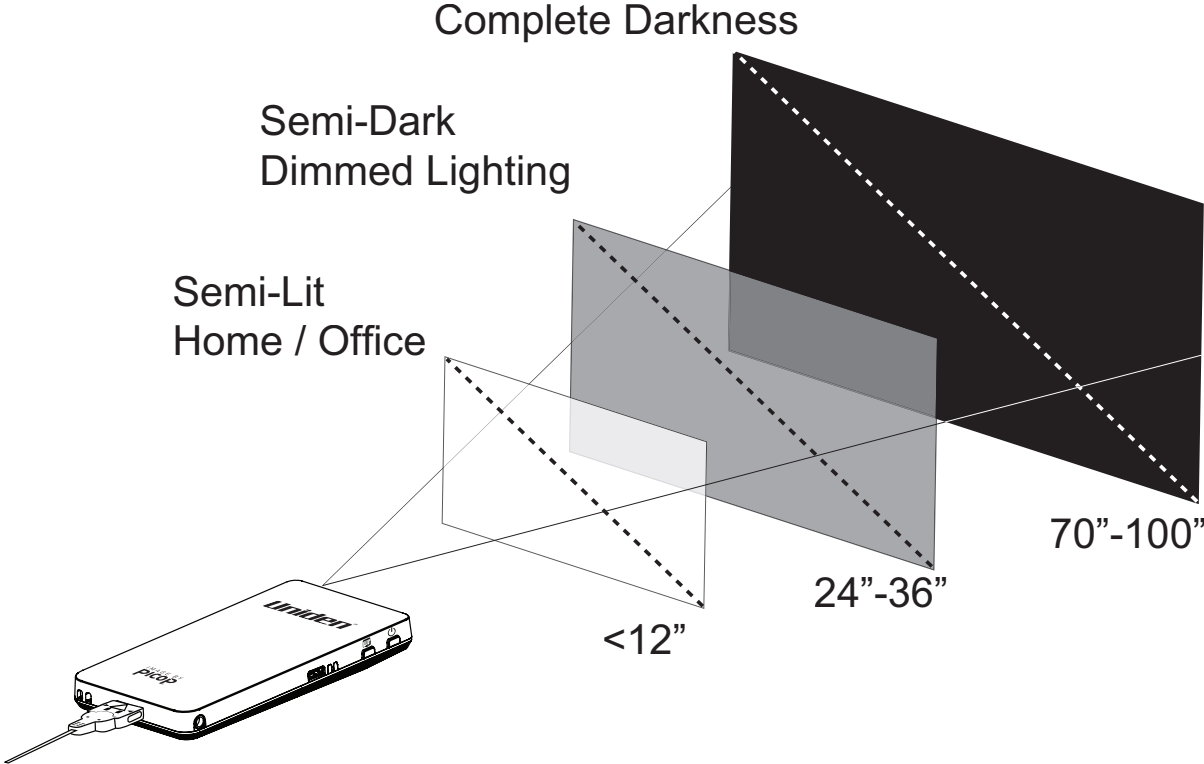

Note: Image diagonal is approximately equal to the distance from the projector to the screen.

Connect to a Video Source

The ULP1000 can connect to a variety of devices with TV-out such as an iPod®, a laptop, cell phone, camera, and more.

The following describes the connectivity options available with the ULP1000.

Cable	Connect ULP1000 to...	Included
ULP1000 Cable for iPod	iPod with Component TV-out	Yes
ULP1000 Composite Video Adapter (NTSC/PAL)	Any device with a male RCA Video out connection	Yes
ULP1000 VGA Dock	Laptop and PC devices	Yes

To see compatible devices with the ULP1000 visit www.uniden.com.au

How to Connect to an Apple iPod®

- 1 Power on the projector

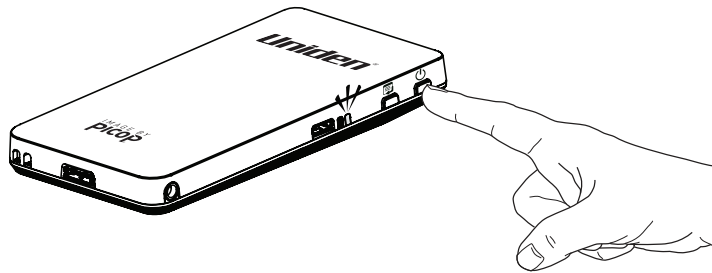

- 2 Connect the cable to the projector

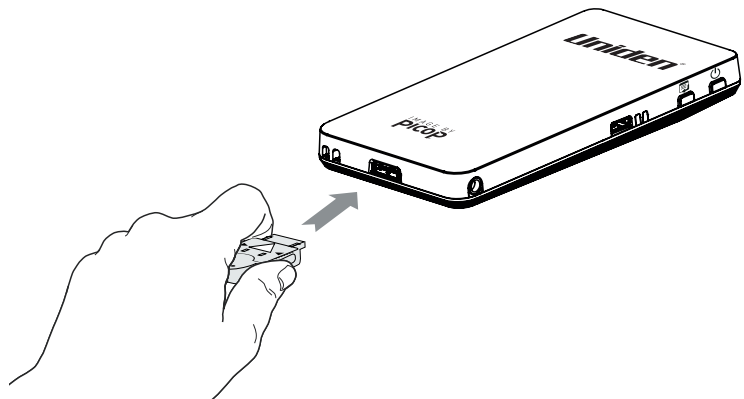

- 3 Connect the cable to the iPod (already on)

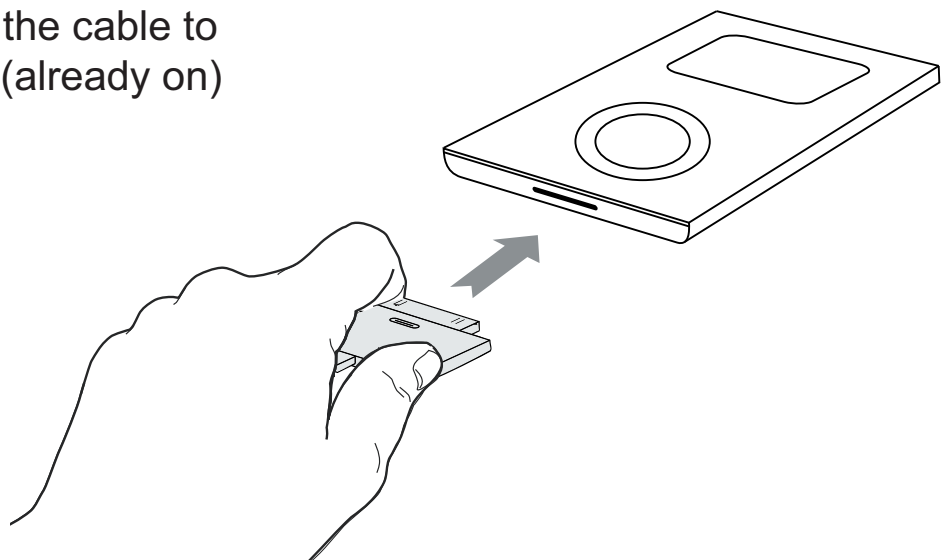

- 4 Wait to see "Ready To Use" alert

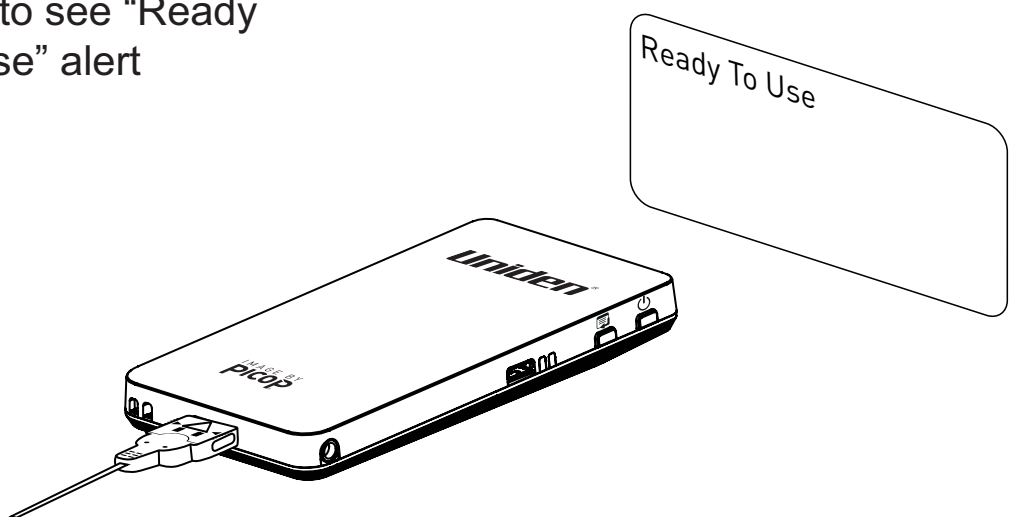

- 5 Select Picture or Video content and Press play on iPod

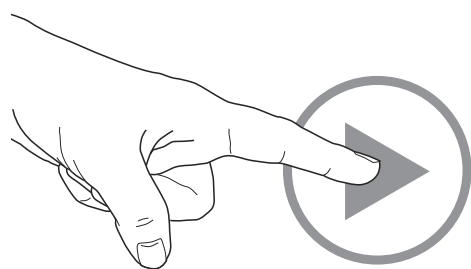

Note:

- » While connected to an iPod, the Audio Jack on the iPod can also be used.
- » To see compatible devices with the ULP1000 visit www.uniden.com.au

Connecting to Other Composite (TV-out) Video Sources

The ULP1000 can connect to other video sources that have Composite (TV-out) using the included Composite adapter. To display content, make sure the source device has TV-out set to “ON” or “Enabled”. To learn if your video source device is capable of TV-out and how to enable, refer to its User Guide.

- 1 Connect the adapter to the projector

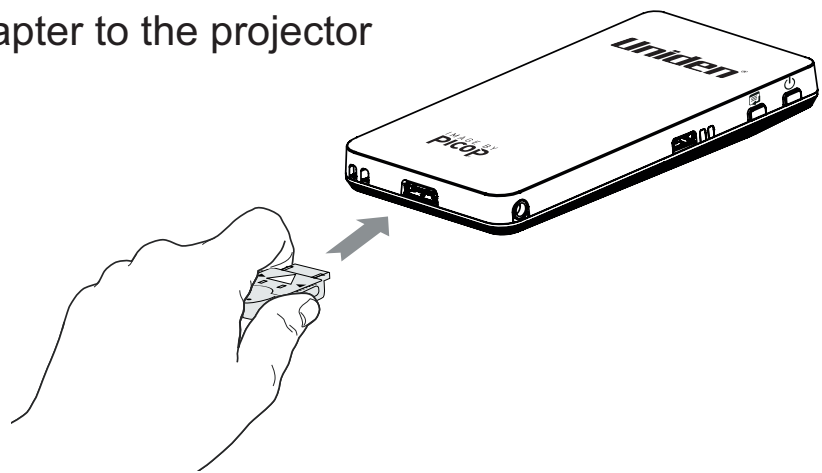

- 2 Connect the Composite adapter to the yellow video RCA connector that is connected to your TV-out device

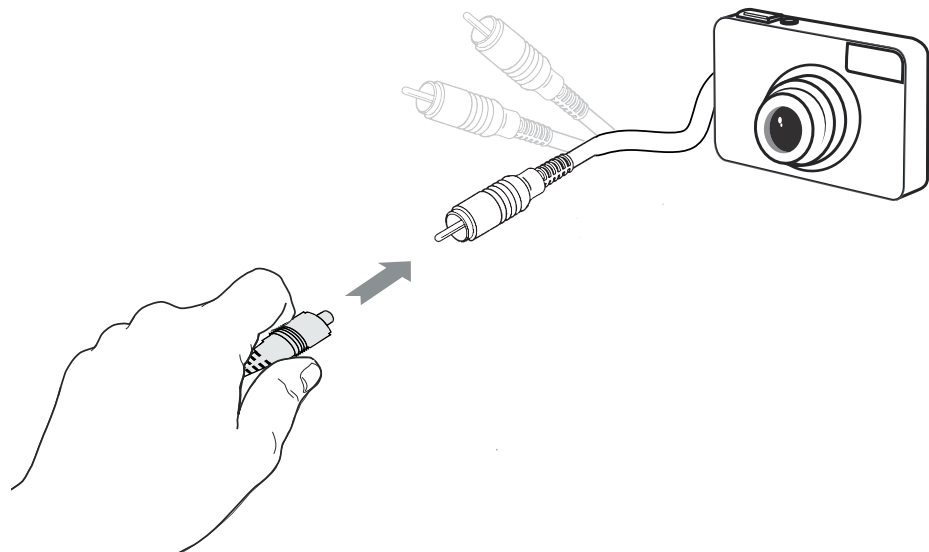

3 Power on the projector

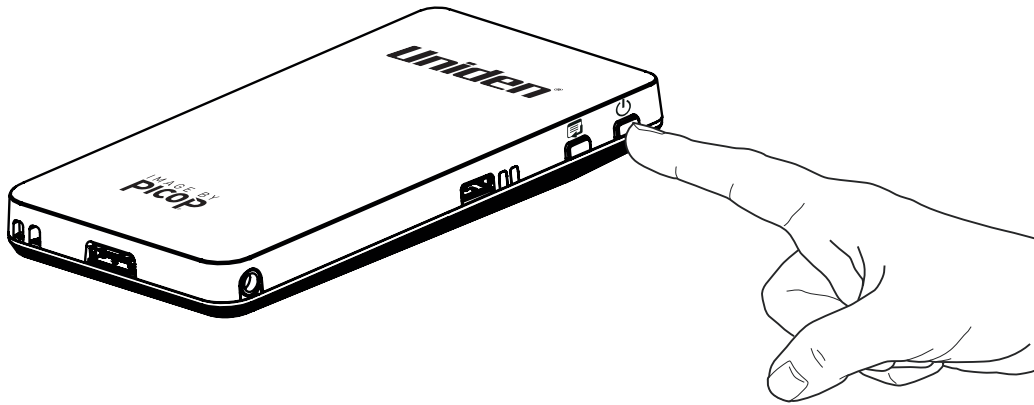

4 Enable video out from source device and play video

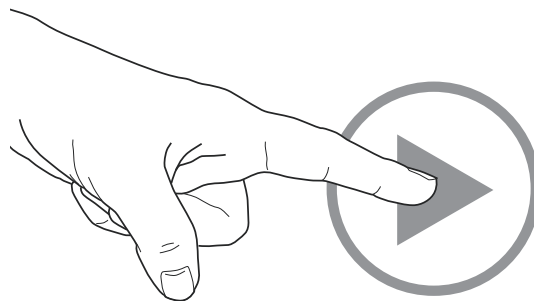

Connecting to a Laptop Computer Using the VGA DOCK

- 1 Turn ON your ULP1000 laser pico projector.

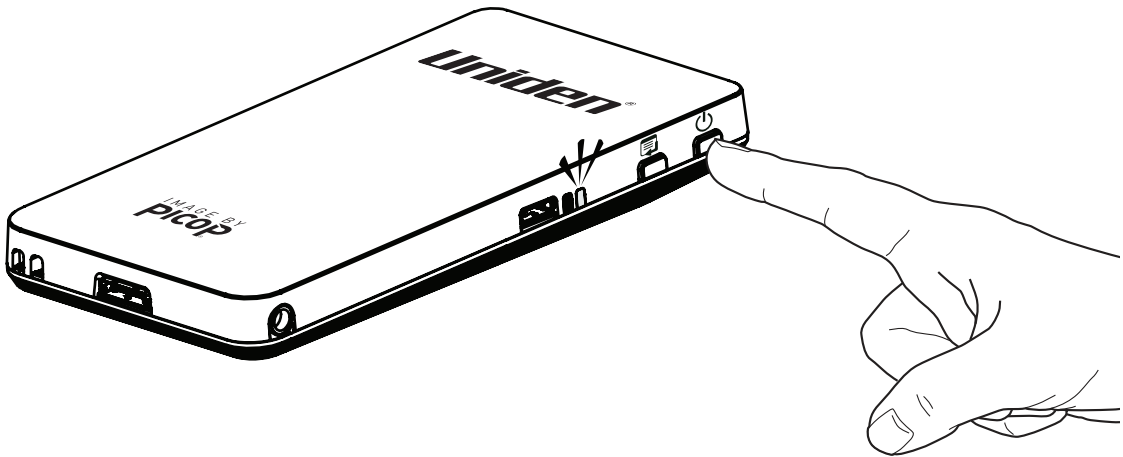

- 2 Turn ON your laptop/computer.

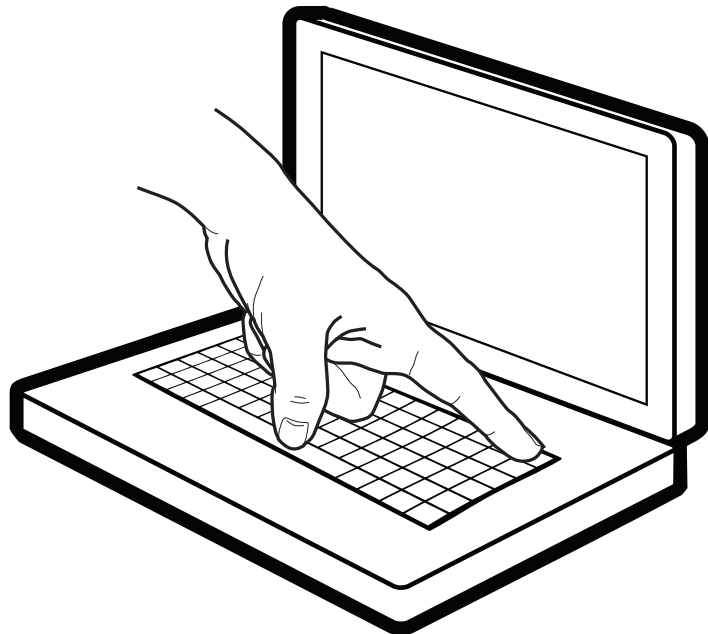

- 3 Connect the ULP1000 VGA DOCK to the monitor port on the laptop computer.

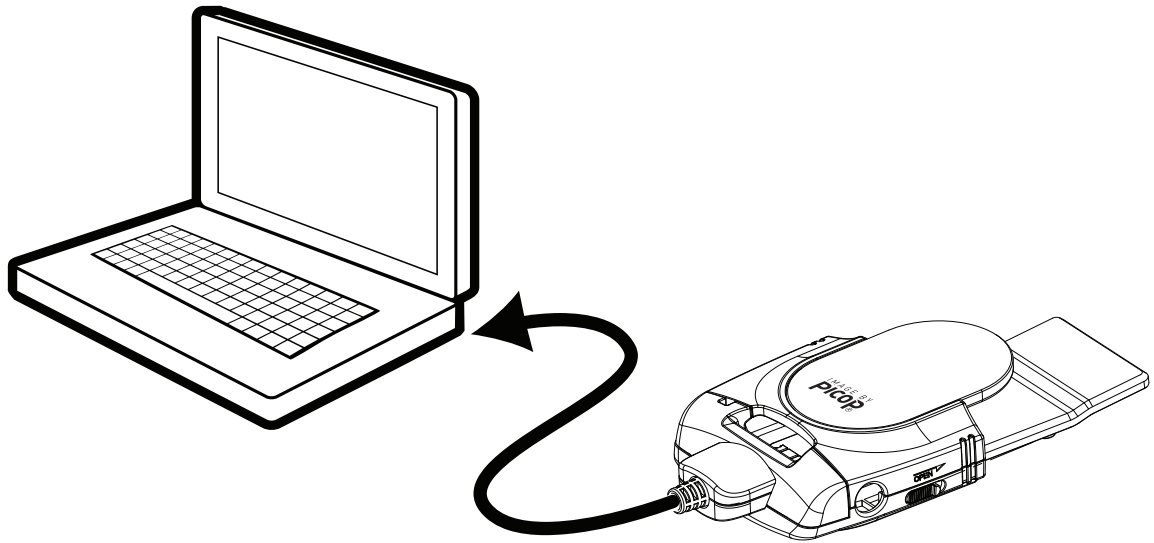

- 4 Unlatch the lid on the VGA DOCK and slide the ULP1000 laser pico projector onto the VGA DOCK.

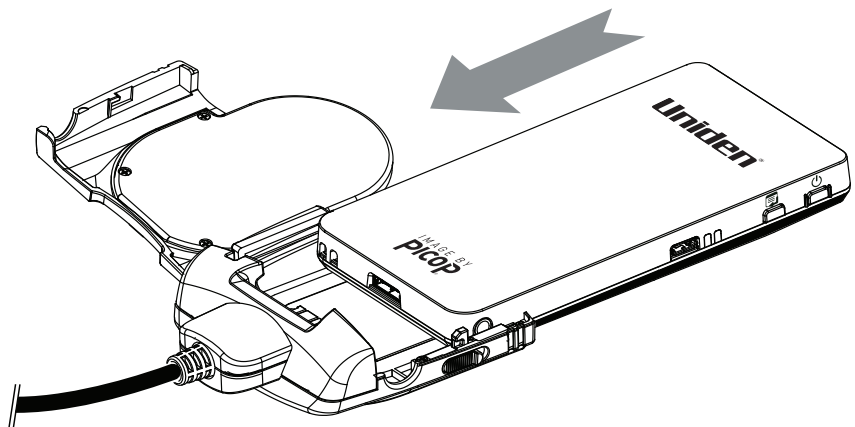

Note:

» When disconnecting, make sure that you unlatch the VGA DOCK properly to avoid scratching or damaging the projector.

» The VGA DOCK should only be used with Uniden's ULP1000 laser pico projector.

VGA DOCK: Computer Display Settings

If needed, enable your external monitor.

Many laptops do not automatically turn on the external video port when a projector is connected. Usually a key combination like FN + F5 or a dedicated Monitor key is required to enable. Typically you can press the FN key and the Monitor key simultaneously. Refer to your laptop's documentation to learn how your laptop can connect to a projector.

Monitor or LCD/CRT Key

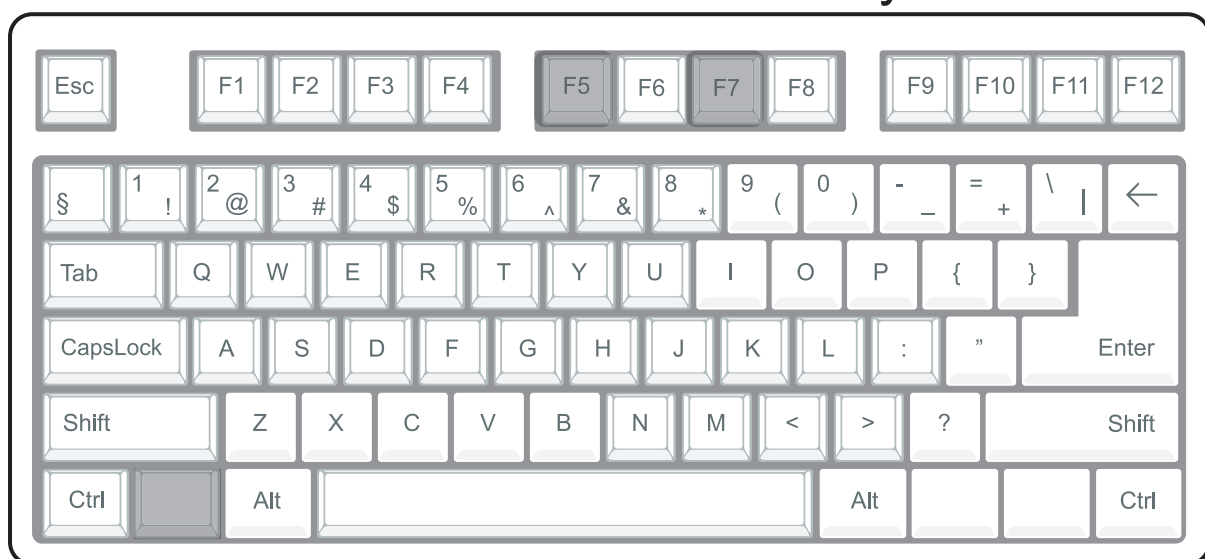

FN Key

» For the best image quality, we recommend you set the laptop resolution to match the projector's native resolution. If the native resolution is not available, try to select one of the other supported resolutions.

» Some computers may require you to manually select the resolution within the computer's display settings. This can usually be found in; *Control Panel > Displays > Settings > Advanced > Adapter > List All Modes > Select supported mode > OK*

Refresh rate should be set to 60 Hertz.

Colour quality should be 32 or 16-bit colour

Supported Resolutions

» Some computers may not be capable of displaying all the resolutions of the ULP1000. Select the highest one available.

» If you see a warning “Video not Supported” please select one of the supported resolutions of the ULP1000.

The ULP1000 supports the following resolutions:

WVGA 848 X 480 (native)

WVGA2 800 x 400

VGA 640 x 480

Computer Compatibility

Fully compatible

All three resolutions with intuitive/easy set-up

» Windows XP with Intel Graphics card - see page 24

» Windows Vista PCs - see page 26

» Windows 7 PCs - setup will be similar to Windows Vista setup

» All MacBooks running OSX

Partially compatible

Typically, VGA only possible with advanced user set-up

» Typically, Windows XP with NVIDIA or ATI Graphics card

- refer to FAQ on our website;

www.uniden.com.au

www.uniden.co.nz

Incompatible

Will not connect, even after advance set-up

» Typically PCs without VGA and at least 16 bit colour in “list all modes”

Windows XP Display Settings

In Windows XP, you can quickly display which display modes (screen resolution, colour depth, and refresh rate) are supported by your video card. With this list you can determine if expected modes are not supported by Windows, possibly resulting in searching for an updated driver or open your video card utility software to do the more advance setting.

- 1 Right-click an empty area of your Desktop and choose “Properties”.



- 2 When the “Display Properties” multi-tabbed dialog box appears, click the “Settings” tab.

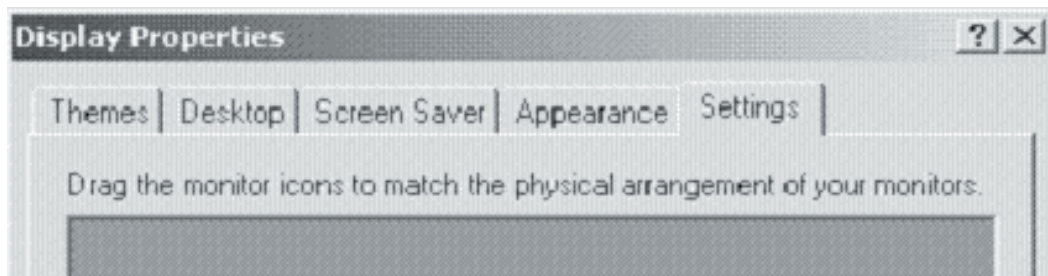

- 3 Click the “Advanced” button.

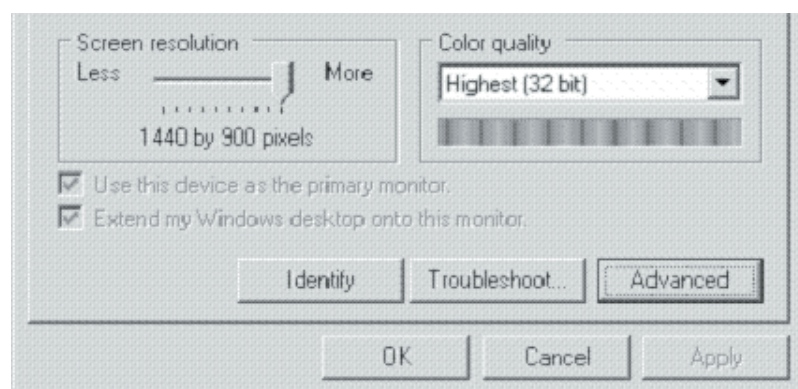

- 4 When the video card dialog box appears, click the “Adapter” tab.

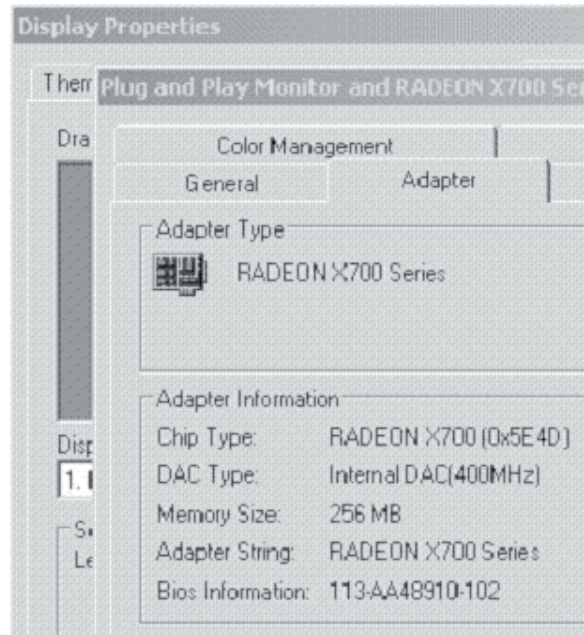

- 5 Click the “List All Modes” button. A “List All Modes” dialog box will appear.



- 6 You can click “Cancel” on the dialog boxes to close them. Or, click on a particular mode you wish to use, then “OK” on the dialog boxes to change to the desired display mode.

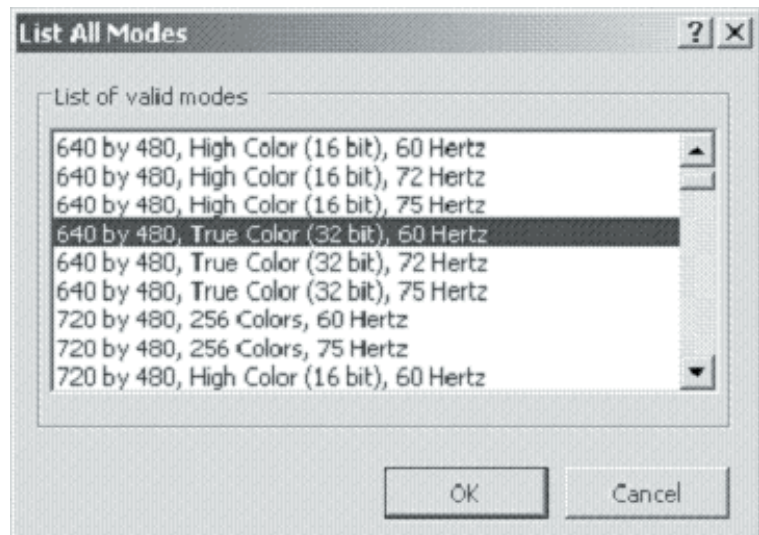

Windows Vista Display Settings

- 1 Launch the Windows Mobility Center by pressing Windows Key+X (or launch the Control Panel and click on Windows Mobility Center).

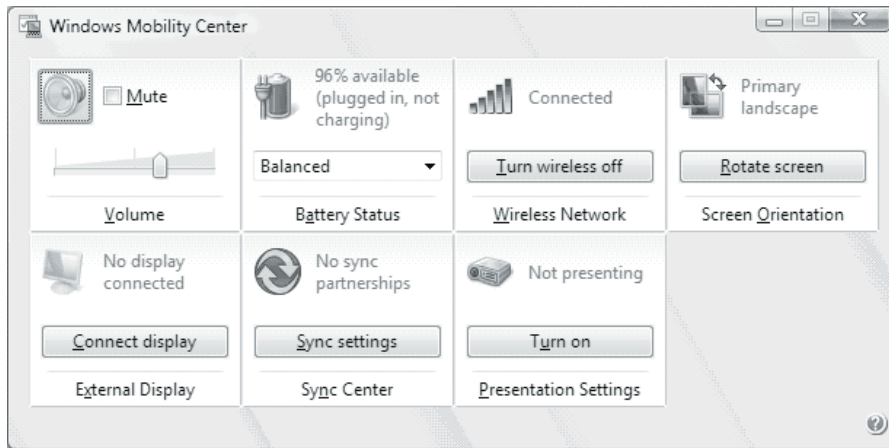

- 2 Click on the Connect Display button in the External Display area of the Windows Mobility Center.
- 3 You may choose:
 - (i) Duplicate my desktop on all displays (mirrored)
 - Your laptop monitor and ULP display the same content
 - (ii) Show different parts of my desktop on each display (extended)
 - Your ULP is the extension of your laptop monitor desktop or the other way around
 - (iii) Show my desktop on the external display only
 - Only use the ULP to display

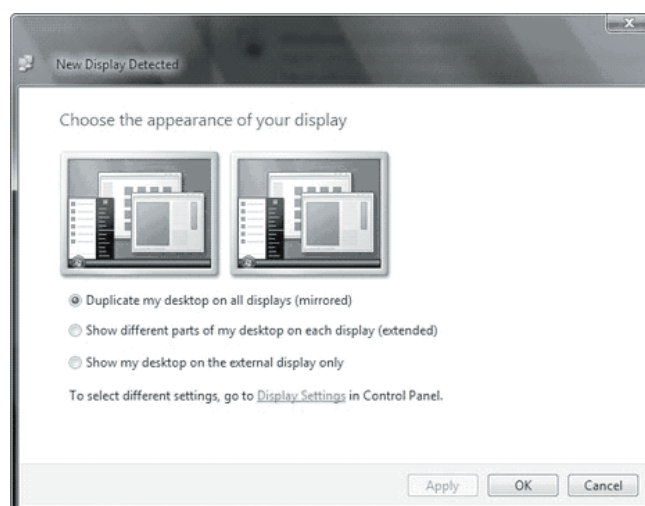

- 4 Then click Apply or OK to continue.

- 5 You may click the Display settings window to further configure your display. 1 stands for Monitor 1 and 2 for Monitor 2.

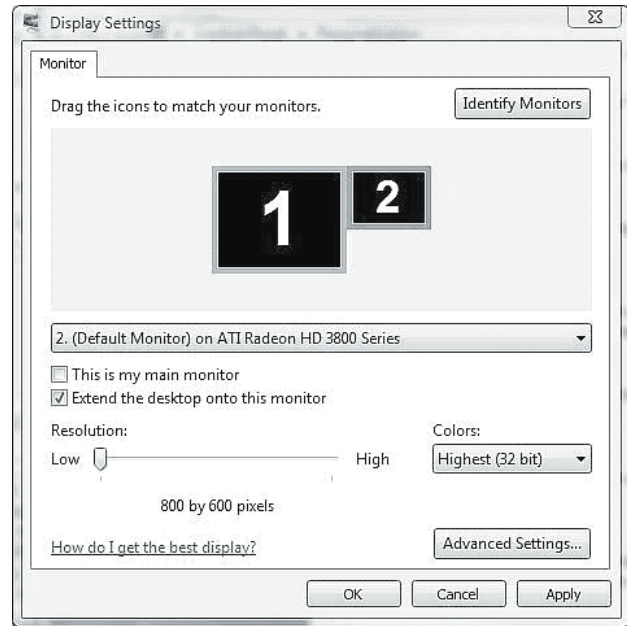

- 6 Next arrange the two monitors to the setup you have. Monitor 1 is your laptop's display and Monitor 2 is your ULP1000 display. So, for example, if your laptop is on the left and the ULP1000 is on the right, drag the two boxes around so that Monitor 1 is on the left and Monitor 2 is on the right.

- 7 Extending the Display:
- Select Monitor 2 in the visual or from the drop-down menu
 - Check the "Extend the desktop onto this monitor" box
 - And then click on **Apply**.

The screen should flash and the extended display is set.

You should now be able to drag a window, from one screen onto another. If you would like to move your Start Menu onto the ULP1000, just drag it onto the other screen. (You may need to right-click and unlock the taskbar first).

Also note that sometimes Windows will choose the lowest resolution of the two displays, so if one of the windows looks wrong, go back to the Display Settings and manually drag the **Resolution** bar to the correct resolutions for each monitor.

Mac OSX

All MacBooks running OSX will be fully compatible with the VGA DOCK.

Advanced Controls

Menu Controls

The ULP1000 was designed as a plug-and-play device, however, some users may want to make adjustments to the settings such as change colours, adjust aspect ratio, and adjust brightness. The following information will help you understand how to fully operate the ULP1000.

Hot Keys

The ULP1000 includes two hot keys to allow the user to quickly adjust the image depending on the type of content being shown.

Color Mode: Colour mode can be changed without going into the Menu screen by pressing the ◀ button to change the colour mode. Press the ◀ button to cycle through the colour modes.

Gamma Mode: Gamma mode can be changed without going into the Menu screen by pressing on the ▶ button. Press the ▶ button to cycle through the gamma modes.

Note: The Color Mode hot key also includes the ability to invert the image. Inverting the image may improve the readability of certain images. Also, if the content background is predominately white, then inverting the image (e.g., white becomes black) will extend battery life.

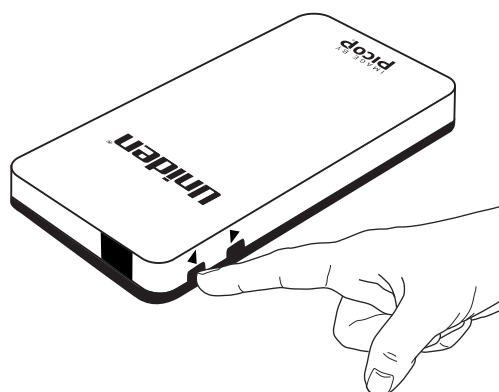





Onscreen Menu

The ULP1000 has an onscreen display to allow the user the ability to make advanced changes to the projector. All settings changed by the user will remain even when powered off.

Brightness:	High (default) / Medium / Low
Color Mode:	Brilliant (default) / Standard / Inverted / Gamma
Aspect Ratio:	Widescreen (default) / Normal / Zoom
System:	Image Alignment / Color Alignment / Properties / Reset Defaults

How to Adjust Brightness

The image brightness can be reduced for close distance viewing in darker environments.

- 1 Press the  button to bring up the on screen menu.
- 2 Use the  or  buttons to navigate to BRIGHTNESS and press .
- 3 Select the desired setting and press  to accept.





How to Change Colour Mode

The ULP1000 has 3 default colour modes.

Brilliant Colours: Bright and vivid colours.





Standard Colours: More accurate flesh tones and grey scales.

Inverted Colours: All colours are inverted. Useful for presentations with black text on white backgrounds.

- 1 Press the  button to bring up the on screen menu.
- 2 Use the  or  buttons to navigate to COLOR MODE and press .
- 3 Select the desired setting and press  to accept.

How to Adjust Aspect Ratio







The image may appear cropped or skinny. The aspect ratio may be different from the video source device.

- 1 Press the  button to bring up the on screen menu.
- 2 Use the  or  buttons to navigate to ASPECT RATIO and press .
- 3 Select the desired setting and press  to accept.

How to Adjust the Image Alignment















The image may appear to be slightly fuzzy. Adjustment of the image alignment may be necessary.

- 1 Press the  button to bring up the on screen menu.

- 1 Press the  button to bring up the on screen menu.
- 2 Use the  or  buttons to navigate to SYSTEM and press .
- 3 Navigate to IMAGE ALIGNMENT and press .
- 4 Press the  or  buttons to adjust the image until all vertical lines appear sharp and clear.

How to Adjust the Colour Alignment

Users can adjust horizontal or vertical alignment of each individual colour (red, green, and blue).





- 1 Press the  button to bring up the on screen menu.
- 2 Use the  or  buttons to navigate to SYSTEM and press .
- 3 Use the  or  buttons to navigate to COLOR ALIGNMENT and press .
- 4 An image of a vertical and horizontal crossed in the middle will appear in the center of the screen.
- 5 Use the  or  buttons to select the desired colour (Red Adjust, Green Adjust, Blue Adjust) to adjust and press .
- 6 Use the  or  buttons to select either HORIZONTAL or VERTICAL ADJUSTMENT and press .
- 7 Use the  or  buttons to move the selected colour until a solid white line is visible either vertically or horizontally.



Note:

- » When adjusting colours HORIZONTALLY use the Vertical line (top-bottom) as the reference.
- » When you exit the configuration menu after image alignment it will take 10 seconds for the normal image to appear.

How to Reset Default Settings





To reset all user selectable settings to factory defaults.

- 1 Press the  button to bring up the on screen menu.
- 2 Use the  or  buttons to navigate to SYSTEM and press .

- 3 Use the ◀ or ▶ buttons to navigate to RESET DEFAULTS and press .
- 4 Press the ◀ or ▶ buttons to select YES and press .

How to Check Remaining Battery Life

Follow these instructions to view how much battery life is remaining.

- 1 Press the  button to bring up the on screen menu.
- 2 Use the ◀ or ▶ buttons to navigate to SYSTEM and press .
- 3 Use the ◀ or ▶ buttons to navigate to PROPERTIES and press .
- 4 Use the ◀ or ▶ buttons to navigate to BATTERY INFORMATION and press .

Care & Maintenance

How to Clean the Window

- 1 Fingerprints and other debris may impact the image quality. Keep the window clean for best image quality.
- 2 Apply a non-abrasive camera lens cleaner to a soft, dry cloth. Lightly wipe the cleaning cloth over the window until clean.

Note:

- » Do not attempt to use solvents or other harsh chemicals as it may damage the window.
- » Make sure cleaning cloth is free of dust or debris to avoid scratching the window.

How to Store & Transport

Proper care should be taken to safely store and transport the projector. To store and transport the ULP1000 use the included storage pouch. Use care and do not drop the ULP1000 or spill liquids on it.

How to Use the Audio Jack

The audio jack on the ULP1000 works only when the Audio signal is combined with the Video signal. The Audio Jack is for output only.

Troubleshooting

Problem	Cause	Solution
The projector does not turn on.	Battery not inserted correctly. Battery not charged.	Make sure the battery is correctly inserted. Make sure the battery is fully charged.
The projector colours look incorrect.	Different Colour Mode may be selected.	Change to preferred Colour Mode.
The projector randomly turns off but the Blue LED stays on.	The projector may be out of the recommended operating range.	Make sure the projector is well ventilated and within the operating temperature range. Turn off for 5 minutes and restart.
Not working with my iPod.	Incompatible iPod, - OR - Incorrect video mode.	Make sure the iPod has TV-out functionality and is enabled. Make sure the ULP1000 video mode is correct for the cable being used.
The projector won't turn off or on and the Blue LED stays on.	System is frozen.	Press and hold the Power button for 20 seconds. If this does not work, remove battery. Then re-insert and turn on.
The projector doesn't work with my cell phone.	Not all cell phones have the TV-out feature.	Refer to your cell phone manufacturer's user guide if TV-out is available and how to configure.
The image looks a little fuzzy.	Debris on Window, - OR - Image is misaligned.	Clean the Window, -OR- Adjust Image Alignment.
The green LED keeps blinking while charging.	The battery is not correctly inserted in the ULP1000.	Make sure battery is correctly inserted into the ULP1000.

Problem	Cause	Solution
The red LED is blinking.	Out of operating range. Temporary problem.	Turn projector off. Remove battery. Re-insert and power on.
Battery doesn't charge.	Battery may not be capable of holding a charge.	Install new battery.
The red LED is constantly on even after trying to restart.	System failure.	Contact Customer Support.

LED Status & Meaning

LED Status	Meaning
Solid Blue	ULP1000 is powered on
Blinking Blue	ULP1000 is powering up
Solid Orange	Battery is charging
Solid Green	Battery is fully charged
Blinking Orange	Battery is low
Blinking Red	Temporary problem
Solid Red	System failure

Customer Support

For Technical Questions, service and support please visit us online at;
 Australia www.uniden.com.au
 New Zealand www.uniden.co.nz

Please have your Serial Number and purchase information available.
 You can find the Serial Number located under the battery.

One Year Limited Warranty

ONE YEAR LIMITED WARRANTY UNIDEN ULP1000 POCKET PROJECTOR

IMPORTANT:

Evidence of original purchase is required for warranty service.

WARRANTOR:

Uniden Australia Pty Limited A.B.N. 58 001 865 498

Uniden New Zealand Limited

Warranty only available in original country of purchase.

ELEMENT OF WARRANTY:

Uniden warrants to the original retail owner for the duration of this warranty, its UNIDEN ULP1000 POCKET PROJECTOR (herein after referred to as the Product), to be free from defects in materials and craftsmanship with only the limitations or exclusions set out below.

WARRANTY DURATION:

This warranty to the original retail owner only, shall terminate and be of no further effect ONE (1) year after the date of original retail sale.

This warranty will be deemed invalid if the Product is;

- (A) Damaged or not maintained as reasonable and necessary,
- (B) Modified, altered or used as part of any conversion kits, subassemblies, or any configurations not sold by Uniden,
- (C) Improperly installed,
- (D) Repaired by someone other than an authorized Uniden Repair Agent for a defect or malfunction covered by this warranty,
- (E) Used in conjunction with any equipment or parts or as part of a system not manufactured by Uniden, or
- (F) Where the Serial Number label of the product has been removed or damaged beyond recognition.

Warranty only valid in the country of original retail/sale.

PARTS COVERED:

This warranty covers for one (1) year, the Product and included accessories.

STATEMENT OF REMEDY:

In the event that the Product does not conform to this warranty at any time while this warranty is in effect, the warrantor at its discretion will repair the defect or replace the Product and return it to you without charge for parts or service. This warranty does not provide for reimbursement or payment of incidental or consequential damages.

This EXPRESS WARRANTY is in addition to and does not in any way affect your rights under the TRADE PRACTICES ACT 1974 (Cth) (Australia) or the CONSUMER GUARANTEES ACT (New Zealand).

PROCEDURE FOR OBTAINING PERFORMANCE OR WARRANTY:

In the event that the Product does not conform to this warranty, the Product should be shipped or delivered, freight pre-paid, with evidence of original purchase (e.g. a copy of the sales docket), to the warrantor at:

UNIDEN AUSTRALIA PTY LIMITED**SERVICE DIVISION**

345 Princes Highway, Rockdale NSW 2216

Fx(02) 9599 3278

www.uniden.com.au

UNIDEN NEW ZEALAND LIMITED**SERVICE DIVISION**

150 Harris Road, East Tamaki, Manukau 2013

Fx(09) 274 4253

www.uniden.co.nz

Customers in other States should ship or deliver the Product freight pre-paid to their nearest Uniden Authorized Repair Centre (Contact Uniden for the nearest Warranty Agent to you).

Uniden[®]

© 2009 Uniden Australia Pty. Limited.
Uniden New Zealand Limited. Printed in PRC.
DA0126853-001